

Spicer® 175 Series Single Reduction Drive Axle

Reliable and durable single drive axle for heavy-duty applications



SPICER®

Drivetrain Products



Durable, reliable, efficient, and lightweight single drive axle.

Designed for 4x2, 6x2, and 8x2 applications up to 28,660 lbs. (13 tonnes) GAWR, this new axle technology includes superfast ratios to help enable extreme engine downspeeding and optimize vehicle efficiency performance with direct-drive and overdrive transmissions.

Spicer® 175 Series Single Reduction Drive Axle



Lightweight without compromising strength

Today, customers are looking for a lighter weight drive axle that provides reliability, strength, and efficiency. They'll find it here.

Product benefits include:

- Engineered and built with advanced manufacturing processes for greater efficiency and durability within a lightweight design.
- Ideally suited for 4x2, 6x2, and 8x2 vehicle configurations.
- Offers the fastest ratios in the industry to help enable maximized fuel-savings.
- Uses High-Power Density™ AdvanTEK® technology and supports engines up to 2,750 Nm of torque. Ratings are subject to Dana engineering application approval (some limitations may apply).
- Maximizes efficiency by reducing power-losses with precision gearing, extra-high efficiency bearings, and a patented lube management system.
- Features a premium integrated ring-gear and flange-half diff-case design reducing weight and oil churning losses while maintaining serviceability.
- Ideally paired with a tag axle for use in the EconoTrek™ 6x2 tandem axle, providing weight savings of up to 380 pounds versus standard 6x4 tandem axles.
- Driver-controlled diff-lock, SelecTTrac™ housing track width, and 12.5 mm housing wall thickness are available as options.

Optional Features

- Heavy-duty wall designs for severe-service applications.
- Integrated, driver-controlled wheel differential lock for maximum traction and spin-out protection.
- SelecTTrac™ option enables use of dual or single-wide-based tires.



REDUCED MAINTENANCE COSTS

A reliable, autonomous lube management system requires less lube while utilizing a patent-pending lube meter to optimize the amount of lube flow to the high-efficiency bearings.

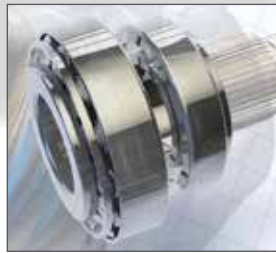

GREATER EFFICIENCY

Stronger bearings designed to reduce friction and spin loss while increasing long-term durability.



LIGHTWEIGHT

With more than 40 pounds (18.14 kg) of weight savings, this new single axle is lightweight without compromising performance and durability.

Axle Specifications

Axle Model	Ratings		Ratios	Axle Shaft			Nominal Ring Gear Diameter	Axle Housing			Spindle Type	Wheel-end Series	Options				
	Max. GAW	Max. GCW		Body Diameter	Number of Splines	Spline Diameter		Box Section Width	Box Section Height	Wall Thickness at Spring Seat			LMS Hub	SelecTTrac™	Differential Lock	Thickwall Housing	
S21-175	21,000 lbs. [9,525]	115,000 lbs. [52,000]	1.95, 2.05, 2.16, 2.31, 2.47, 2.64, 2.85, 3.07, 3.42	2.06 [52]	46	2.35 [60]	17.9 [455]	4.61 [117]	5.24 [134]	R	N/A		0.5 [12.5] wall thickness			N/A	
S23-175	23,000 lbs. [10,433]																2.25 [57]
S25-175	25,000 lbs. [11,340]			2.06 [52]	46												
EconoTrek™ 6x2 S21-175	40,000 lbs. [18,144]		1.95, 2.05, 2.16, 2.31, 2.47, 2.64, 2.85, 3.07, 3.42									N/A	R		Requires 0.5 [12.5] wall thickness		
				S20-045B (tag axle)													

To learn more about the unique global applications of Dana's latest axle innovation, visit dana.com/cv



Dana Commercial Vehicle Driveline Technologies
3939 Technology Drive
Maumee, Ohio, USA 43537
dana.com



SPICER®
Drivetrain Products

Application Policy

Capacity ratings, features, and specifications vary depending upon the model and type of service. Application approvals must be obtained from Dana; contact your representative for application approval. We reserve the right to change or modify our product specifications, configurations, or dimensions at any time without notice.